

CARATTERISTICHE MECCANICHE - MECHANICAL SPECIFICATIONS

Dimensioni - Dimensions: vedi disegni - see drawings

Albero - Shaft: acciaio inox - stainless steel

Carico sull'albero - Shaft loading: assiale - axial: 200 N; radiale - radial 200 N

Numero giri - Shaft rotational speed: 10.000 RPM per brevi periodi - to short cycle time; 6.000 RPM continui - continuous;
2.000 RPM con asse stagno - with proof shaft

Vita dei cuscinetti - Bearings life: 5×10^6 giri (minimo) - rev. min.

Peso - Weight: ~ 0,52 kg

CARATTERISTICHE ELETTRICHE - ELECTRICAL SPECIFICATIONS

Codici STD - STD codes: GRAY - BINARIO - BCD - ANALOGICO; GRAY - BINARY - BCD - ANALOG

Frequenza in uscita - output frequency: da 0 a 20 KHz (L.S.B. senza errore); from 0 to up 20 KHz (L.S.B. without error)

Protezione - Protection: contro inversione di polarità (escluso 5Vcc); against inversion of polarity (except 5Vcc)

MATERIALI UTILIZZATI - MATERIALS

Corpo - Flange: in alluminio anticorrosivo - aluminium non corroding

Custodia - Housing: Alluminio verniciato con trattamento termico a 180° C; Aluminium painted with inhibiting treatment 180° C

CARATTERISTICHE AMBIENTALI - ENVIRONMENTAL SPECIFICATIONS

Temperatura di lavoro - Operating temperature range: -10° C + +70° C

Temperatura di stoccaggio - Storage temperature range: -30° C + +80° C

Umidità relativa - Relative humidity: 98% RH senza condensazione - RH without condensing

Vibrazioni - Vibrations: 10 g (da 10 a 2.000 Hz) - (From 10 up to 2.000 Hz)

Schock - Schock: 20 g (per 11 ms) - (for 11 ms)



CODICE DI ORDINAZIONE - ORDERING CODE

(TKC50) (XX) (XXXX) (XXXX) (XXXXX) (XX) (XXXX) (XXnn) (XX) (XXXX) (Xnnn)

MONTAGGIO - ASSEMBLY
 F Flangia Quadra - Square flange
 SG Servo-Graffe - servo-clip

Albero - Shaft
 Ø 6 mm
 Ø 8 mm
 Ø 9,52 mm
 Ø 10 mm

Custom

OPZIONI - OPTIONS
 U Up/Down NPN
 D Up/Down PNP
 S Strobe standard (NO x SSI)
 I Strobe invertito - Strobe inverted (NO x SSI)
 Z Segnale di zero - Zero signal (NO x SSI)
 V Zero visualizzato - Zero displayed (NO x SSI)
 E "Even" o parità Pari - Even parity (NO x SSI)
 O "Odd" o parità Dispari - Odd parity (NO x SSI)

CODICE - CODE
A Uscita analogica (1024/360°-180°-90°-45°)
 Analog output (1024/360°-180°-90°-45°)
B codice Binario naturale Binary code natural
B/0 codice Binario troncato centro Binary code centrally cut
B/7 codice Binario leccesso (18) Binary code/exc (18)
B/14 codice Binario leccesso (36) Binary code/exc (36)
B/19 codice Binario leccesso (90) Binary code/exc (90)
B/28 codice Binario leccesso (72) Binary code/exc (72)
B/38 codice Binario leccesso (180) Binary code/exc (180)
B/76 codice Binario leccesso (360) Binary code/exc (360)
B/152 codice Binario leccesso (720) Binary code/exc (720)
B/304 codice Binario leccesso (1440) Binary code/exc (1440)
D codice BCD (100+720) BCD code (100+720)
E codice Gray Exc 3 (100+720) Excess 3 Gray code (100+720)
G codice Gray naturale Natural Gray code
G/0 codice Gray troncato centr Centrally cutted Gray code
G/7 codice Gray leccesso (18) Gray code/exc (18)
G/14 codice Gray leccesso (36) Gray code/exc (36)
G/19 codice Gray leccesso (90) Gray code/exc (90)
G/28 codice Gray leccesso (72) Gray code/exc (72)
G/38 codice Gray leccesso (180) Gray code/exc (180)
G/76 codice Gray leccesso (360) Gray code/exc (360)
G/152 codice Gray leccesso (720) Gray code/exc (720)
G/304 codice Gray leccesso (1440) Gray code/exc (1440)

Alimentazione (Vdc) - Voltage supply
 5 +5 V ±5 % ; 11/30 +11V +30V
 18/30 +18V +30V solo analogico - only analog

Grado di protezione - Protection class
 K1 IP 55 (En60529) solo con D25 - with D25 only
 K4 IP 64 (En60529)
 Con S13D solo K4 - With S13D only K4

IMPULSI GIRO - PULSE RATE

16	16	passi/giro	G/B	steps/turn	G/B	360	360	passi/giro	G/B	steps/turn	G/B
18	18	passi/giro	G/B	steps/turn	G/B	400	400	passi/giro	G/B	steps/turn	G/B
32	32	passi/giro	G/B	steps/turn	G/B	500	500	passi/giro	G/B	steps/turn	G/B
36	36	passi/giro	G/B	steps/turn	G/B	512	512	passi/giro	G/B	steps/turn	G/B
64	64	passi/giro	G/B	steps/turn	G/B	720	720	passi/giro	G/B	steps/turn	G/B
90	90	passi/giro	G/B	steps/turn	G/B	900	900	passi/giro	G/B	steps/turn	G/B
100	100	passi/giro	G/B	steps/turn	G/B	1000	1000	passi/giro	G/B	steps/turn	G/B
128	128	passi/giro	G/B	steps/turn	G/B	1024	1024	passi/giro	G/B	steps/turn	G/B
180	180	passi/giro	G/B	steps/turn	G/B	1440	1440	passi/giro	G/B	steps/turn	G/B
200	200	passi/giro	G/B	steps/turn	G/B	2000	2000	passi/giro	G/B	steps/turn	G/B
250	250	passi/giro	G/B	steps/turn	G/B	2048	2048	passi/giro	G/B	steps/turn	G/B
256	256	passi/giro	G/B	steps/turn	G/B						

CIRCUITI DI USCITA - OUTPUT CIRCUITS

00	TTL log+ (solo 5V - 5 V only)	10	NPN 40 mA Open Collector log+
01	TTL log- (solo 5V - 5 V only)	11	NPN 40 mA pull-up log+ (solo 11/30V - 11/30V only)
02	TTL 3-state log+ (solo 5V - 5 V only)	12	NPN 40 mA Open Collector log-
03	TTL 3-state log- (solo 5V - 5 V only)	13	NPN 40 mA pull-up log- (solo 11/30V - 11/30V only)
50	TTL log+ Latch (solo 5V - 5V only)	60	NPN open collector + latch
51	TTL log- Latch (solo 5V - 5V only)	61	NPN 40 mA pull-up log+ Latch (solo 11/30V - 11/30V only)
52	TTL 3-state log+ Latch (solo 5V - 5V only)	62	NPN 40 mA Open Collector log-
53	TTL 3-state log- Latch (solo 5V - 5V only)	63	NPN 40 mA pull-up log- Latch (solo 11/30V - 11/30V only)
20	PNP 100 mA Open Collector log+	31	Uscita analogica 4+20 mA (solo 18/30V) Analog output 4+20 mA (18/30V only)
21	PNP 100 mA pull-down log+ (solo 11/30V - 11/30V only)	32	Uscita analogica 1+5 V (solo 18/30V) Analog output 1+5 V (18/30V only)
22	NPN 100 mA Open Collector log-	33	Uscita analogica 0+10 V (solo 18/30V) Analog output 0+10 V (18/30V only)
23	NPN 100 mA pull-up log- (solo 11/30V - 11/30V only)	70	PNP 100 mA Open Collector log+ Latch
30	Push Pull protetto cc (solo 11/30V) Push Pull cc protect (11/30V only)	71	PNP 100 mA pull-down log+ Latch (solo 11/30V-11/30V only)
70	PNP 100 mA Open Collector log+ Latch	72	NPN 100 mA Open Collector log Latch
71	PNP 100 mA pull-down log+ Latch (solo 11/30V-11/30V only)	73	NPN 100 mA pull-up log- Latch
72	NPN 100 mA Open Collector log Latch	80	Push Pull protetto cc Latch (solo 11/30V-11/30V only)
S13D	SSI 13 bit allin destra (solo 11/30V) - SSI 13 bit right alignment (11/30V only)		

CONNESSIONI ELETTRICHE - ELECTRICAL CONNECTIONS

P pressacavo assiale con cavo da 1 a 6 m; on axial cable gland with cable 1 + 6 m long
 PL pressacavo radiale con cavo da 1 a 6 m; radial cable gland with cable 1 + 6 m long
 S 07 connettore circolare militare assiale a 7 pidi; on 7 pins axial MIL connector
 S 10 connettore circolare militare assiale a 10 pidi; on 10 pins axial MIL connector
 S 26 connettore circolare militare assiale a 26 pidi; on 26 pins axial MIL connector
 D 25 connettore submin. assiale a 25 pidi; on 25 pins axial DB25 connector
 SL 07connettore circolare militare radiale a 7 pidi; on 7 pins radial MIL connector
 SL 10connettore circolare militare radiale a 10 pidi; on 10 pins radial MIL connector
 SL 26connettore circolare militare radiale a 26 pidi; on 26 pins radial MIL connector

nn Lunghezza cavo - Cable length (es. PL10 = 1 m. ... PL60 = 6 m)

18	18	passi/giro	G/7;B/7	steps/turn	G/7;B/7	90	90	passi/giro	G/0;B/0	steps/turn	G/0;B/0	1024/360	1024	passi/360° (solo uscita analogica) 1024 steps/360° (analog output only)			
36	36	passi/giro	G/14;B/14	steps/turn	G/14;B/14	180	180	passi/giro	G/0;B/0	steps/turn	G/0;B/0	512/180	512	passi/180° (solo uscita analogica) 512 steps/180° (analog output only)			
72	72	passi/giro	G/28;B/28	steps/turn	G/28;B/28	250	250	passi/giro	G/0;B/0	steps/turn	G/0;B/0	256/90	256	passi/90° (solo uscita analogica) 256 steps/90° (analog output only)			
90	90	passi/giro	G/19;B/19	steps/turn	G/19;B/19	360	360	passi/giro	G/0;B/0	steps/turn	G/0;B/0	128/45	128	passi/45° (solo uscita analogica) 128 steps/45° (analog output only)			
180	180	passi/giro	G/38;B/38	steps/turn	G/38;B/38	500	500	passi/giro	G/0;B/0	steps/turn	G/0;B/0						
360	360	passi/giro	G/76;B/76	steps/turn	G/76;B/76	720	720	passi/giro	G/0;B/0	steps/turn	G/0;B/0						
720	720	passi/giro	G/152;B/152	steps/turn	G/152;B/152	1000	1000	passi/giro	G/0;B/0	steps/turn	G/0;B/0						
1440	1440	passi/giro	G/304;B/304	steps/turn	G/304;B/304	1440	1440	passi/giro	G/0;B/0	steps/turn	G/0;B/0						
												100	100	passi/giro	E/D	steps/turn	E/D
												250	250	passi/giro	E/D	steps/turn	E/D
												360	360	passi/giro	E/D	steps/turn	E/D
												400	400	passi/giro	E/D	steps/turn	E/D
												500	500	passi/giro	E/D	steps/turn	E/D
												720	720	passi/giro	E/D	steps/turn	E/D
												900	900	passi/giro	E/D	steps/turn	E/D
												1000	1000	passi/giro	E/D	steps/turn	E/D
												1440	1440	passi/giro	E/D	steps/turn	E/D
												2000	2000	passi/giro	E/D	steps/turn	E/D

**MONTAGGIO MECCANICO
MECHANICAL ASSEMBLY**

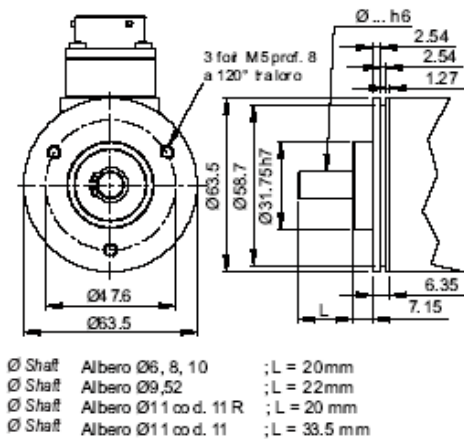
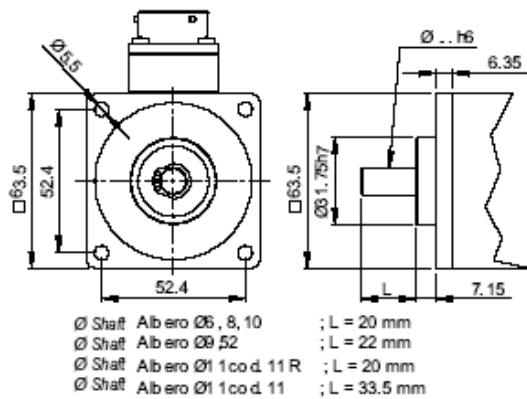

**CONNESSIONI ELETTRICHE
ELECTRICAL CONNECTIONS**

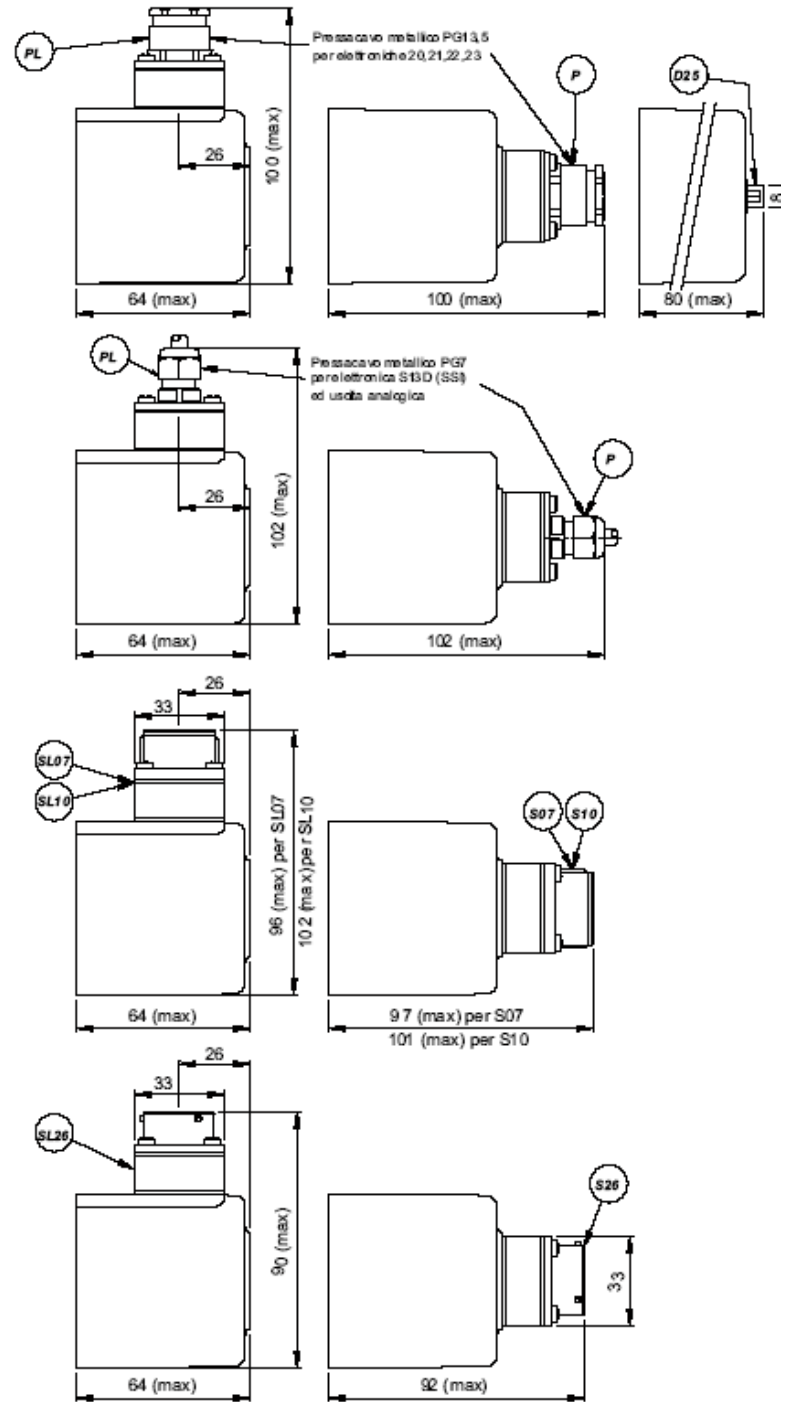

VALORI STROBE - STROBE VALUE

S=	Strobe custom	<i>Strobe custom</i>	S 200	Strobe 20 μ s	<i>Strobe 20 μs</i>
I 200	Strobe invertito 20 μ s	<i>inverted strobe 20 μs</i>	S 500	Strobe 50 μ s	<i>Strobe 50 μs</i>
I 500	Strobe invertito 50 μ s	<i>inverted strobe 50 μs</i>	S 101	Strobe 100 μ s	<i>Strobe 100 μs</i>
I 101	Strobe invertito 100 μ s	<i>inverted strobe 100 μs</i>	S 201	Strobe 200 μ s	<i>Strobe 200 μs</i>
I 201	Strobe invertito 200 μ s	<i>inverted strobe 200 μs</i>	S 501	Strobe 500 μ s	<i>Strobe 500 μs</i>
I 501	Strobe invertito 500 μ s	<i>inverted strobe 500 μs</i>	S 102	Strobe 1 ms	<i>Strobe 1 ms</i>
I 102	Strobe invertito 1 ms	<i>inverted strobe 1 ms</i>	S 202	Strobe 2 ms	<i>Strobe 2 ms</i>
I 202	Strobe invertito 2 ms	<i>inverted strobe 2 ms</i>	S 502	Strobe 5 ms	<i>Strobe 5 ms</i>
I 502	Strobe invertito 5 ms	<i>inverted strobe 5 ms</i>	S 103	Strobe 10 ms	<i>Strobe 10 ms</i>
I 103	Strobe invertito 10 ms	<i>inverted strobe 10 ms</i>	S 203	Strobe 20 ms	<i>Strobe 20 ms</i>
I 203	Strobe invertito 20 ms	<i>inverted strobe 20 ms</i>	S 503	Strobe 50 ms	<i>Strobe 50 ms</i>
I 503	Strobe invertito 50 ms	<i>inverted strobe 50 ms</i>	S 104	Strobe 100 ms	<i>Strobe 100 ms</i>
I 104	Strobe invertito 100 ms	<i>inverted strobe 100 ms</i>	S 204	Strobe 200 ms	<i>Strobe 200 ms</i>
I 204	Strobe invertito 200 ms	<i>inverted strobe 200 ms</i>			