



Model OF46HD-10

- Standard Model Nos.

Bushingmount type:
OF46HD-10 (10-turn)
Servomount type:
OF46HDS-10 (10-turn)

- Standard Dimensions

- Bushingmount Type

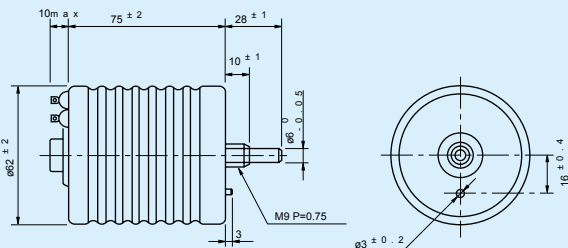

Note: 1 pc. inner teeth washer and 2 pcs. hex nuts are attached

- Servomount Type

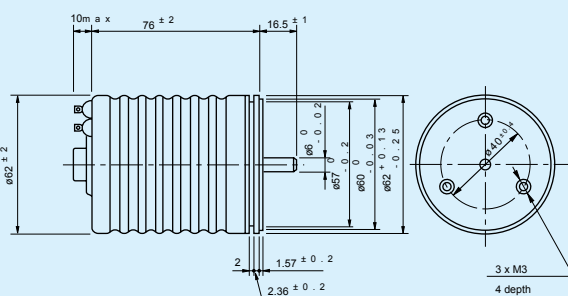

- General Specifications

Standard Resistance

Range: 100Ω to 100kΩ

Max. Practical

Resistance Value: 200kΩ

Total Resistance

Tolerance: Standard Class ±3% (H)
(±5% (J) in case of within 1kΩ)
Precision Class ±1% (K)

Independent Linearity

Tolerance: Standard Class ±0.3%
Precision Class ±0.1%
(±0.15% in case of on and within 5kΩ)

Power Rating: 5.0W

Noise: Within 100Ω E.N.R.

Electrical Travel: 3,600° ±5°

Mechanical Travel: 3,600° ^{+10°}_{0°}

Insulation Resistance: Over 100MΩ at 1,000 V.D.C.

Dielectric Strength: 1 minute at 1,000 V.A.C.

Starting Torque: Within 30mN·m (300gf·cm)

Stopper Strength: Approx. 0.9N·m (9kgf·cm)

Max. Working Voltage: 900V

Resist. Temperature

Coefficient of Wire: ±20p.p.m./°C

Mass: Approx. 290g

- Standard Resistance Values ■ No. of Wire Turns ■ Resistance Wire Used

Resist. Value (Ω)	100	200	500	1k	2k	5k	10k	20k	50k	100k	#200k
No. of wire turns	2, 5 0 0	3, 1 8 0	4, 3 5 0	5, 4 0 0	6, 8 5 0	6, 6 6 0	8, 5 5 0	10, 8 5 0	14, 9 0 0	18, 8 5 0	24, 3 9 0
Resist. wire used	Cu-Ni System					Ni-Cr System					

Note: Mark # shows value at special higher practical resistance

- Special Specifications Available

Multi0ganged (available up to 2 gangs. Please note that mounting method is changed from bushing mount to screw-mounting), with limit-switches, 3-turn and 5-turn type (these housing lengths are the same as that of 10-turn type: 75±2 mm), shaft dia. (∅ 3.175mm) · bushing with inch dimensions, special machining on the shaft, shaft with front and rear extension (rear shaft with 6mm dia. and 28mm length).